

DUCTFORMER

'Rotary Machine'

Beads, Crimps,
Slits & Flanges

**Automatic Feed &
Engage Feature
Leaves Both Hands
Free to Handle Part!**

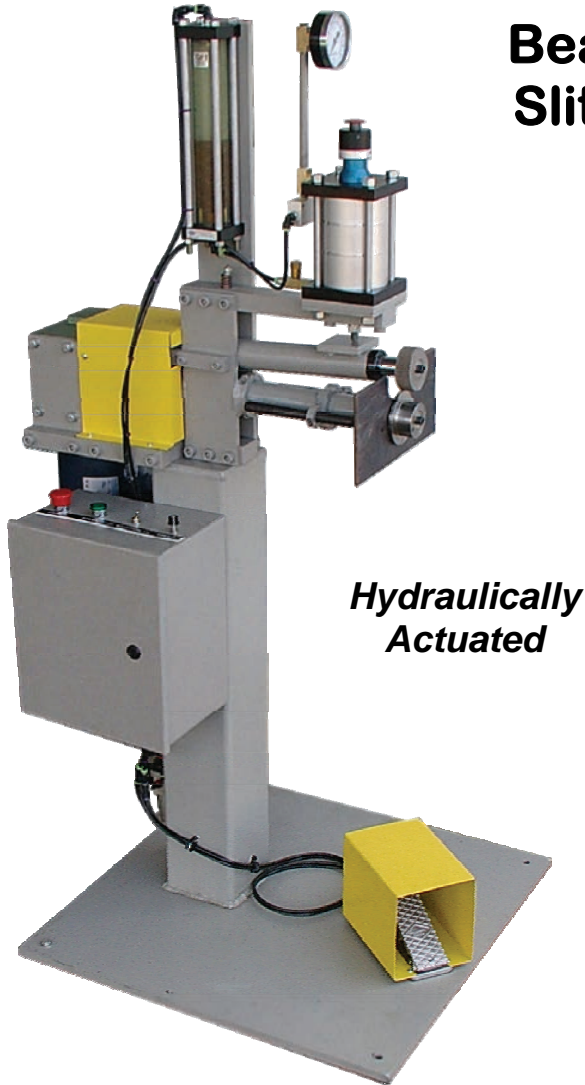

**Hydraulically
Actuated**

Model DFRF-1410 Specifications:

- 1.25" Diameter Roll Shafts
- Heavy Duty Roller Bearings
- Variable Speed Reversible Motor Drive
- 1 HP , 110V Electric
- FORWARD / REVERSE Capabilities
- 10" Throat - 14 Gauge Capacity
- Full Selection of Rolls
- Full Hardened Tool Steel Back Plate
- Maintains maximum Torque at lower speeds
- 1 Year Warranty on Machined Parts

Special Safety Features

**Foot Operation Leaves
Hands Free to Handle
Metal Being Formed!**

**Forming Rolls will Stop &
Retract Automatically to
Load a New Part!**



Made in the USA

Forms Either
Round or Flat Sheets

Foot Pedal Controls
Clamping Force



3991 Green Park Rd. St. Louis, MO 63125
Phone ~ 314.631.1416 Fax ~ 314.631.3003

www.ductformer.com

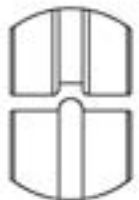

1/4" BEAD

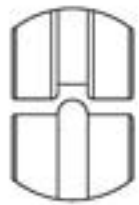

5/16" BEAD



3/8" BEAD



1/2" BEAD



1" BEAD



3/8" FLANGE

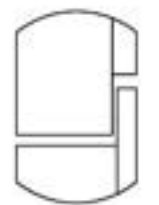

1/2" FLANGE



**GORE
EDGE**

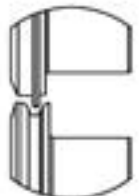

**ELBOW
EDGE**

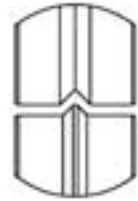

V GROOVE

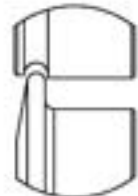

TURNING



SHEAR



**OFFSET
SWEDGE**



OGEE

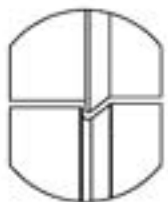

FIRE DAMPER



**2" WIDE
CRIMP ROLL**

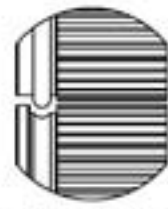

**COMBO 2" CRIMP
& 5/16" BEAD**



1/16" STEP



1/8" STEP



3/16" STEP

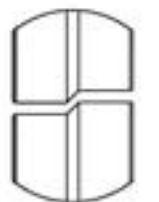

45° STEP



**FLAT HEM 3/8"
STEP 1**



**FLAT HEM 1/4"
STEP 1**



**FLAT HEM
STEP 2**



**FLAT HEM
STEP 3**



**SPIN COLLAR
STEP 2**



**SPIN COLLAR
STEP 1**

